

AltoUpdate...

MAKE	TRANSMISSION	APPLICATION	YEAR
GM	N/A	Aluminum Powerglide	Various
DESCRIPTION & NOTES...			

Powerband® for Aluminum Racing Powerglide...

Alto #019961, #019961K, #019962 & #019962K

The Alto Hi-Performance GM aluminum racing Powerglide Powerband™ is the holding element whenever the unit is in low gear. The Alto Powerband™ is engineered wider than the OE style band (.336" wider); therefore giving 15% more holding capacity. Anchors have been offset to insure proper alignment when installed. The Alto Powerband™ will be offered in Red Eagle® and Kevlar®. This larger capacity band will be very beneficial for the Hi-Performance end user. This band is also available with grooves in the #19962 and #19962K.

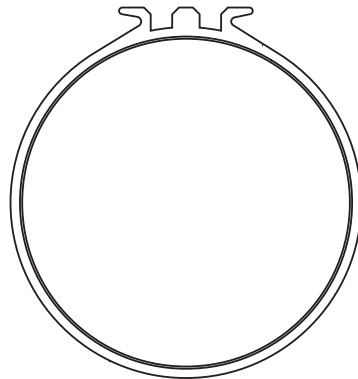
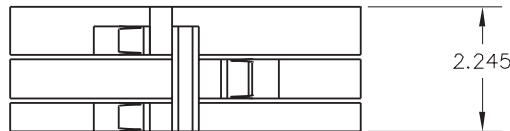

Installation: This band is 15% wider than the OE style band. This new band will make contact on the surface of the drum in a previously unused area and special attention needs to be given to the front clutch drum. Condition the surface of the drum in order to have a uniform flat surface for the Alto Powerband™ to ride on. Otherwise, installation and adjustment is the same as OE specifications.

Call Customer Service for Availability.

Alto Way • PO Box 1088 • Atmore • AL • 36504
Tel: 251.368.7777 • Fax: 251.368.7774 • www.altoUSA.com

Clutches and Gears for Automatic and Standard Transmissions

0309001

